

ISO A1 594mm x 841mm  
 Approved:  
 Checked:  
 Designer:  
 Project Management Initials:  
 Last saved by: ANGELA ESPPOSITO(2019-08-16) | Last Printed: 2019-08-16  
 Filename: Z:\UK\URBAN\Z\05\IPR-406711\_SCHE\_CISM\_BAT\_CAMIPUS400\_TECHNICAL\434\_CEDRAWINGS\CURRENT\60605215-ACM-XX-DR-CE-001\_P01.DWG

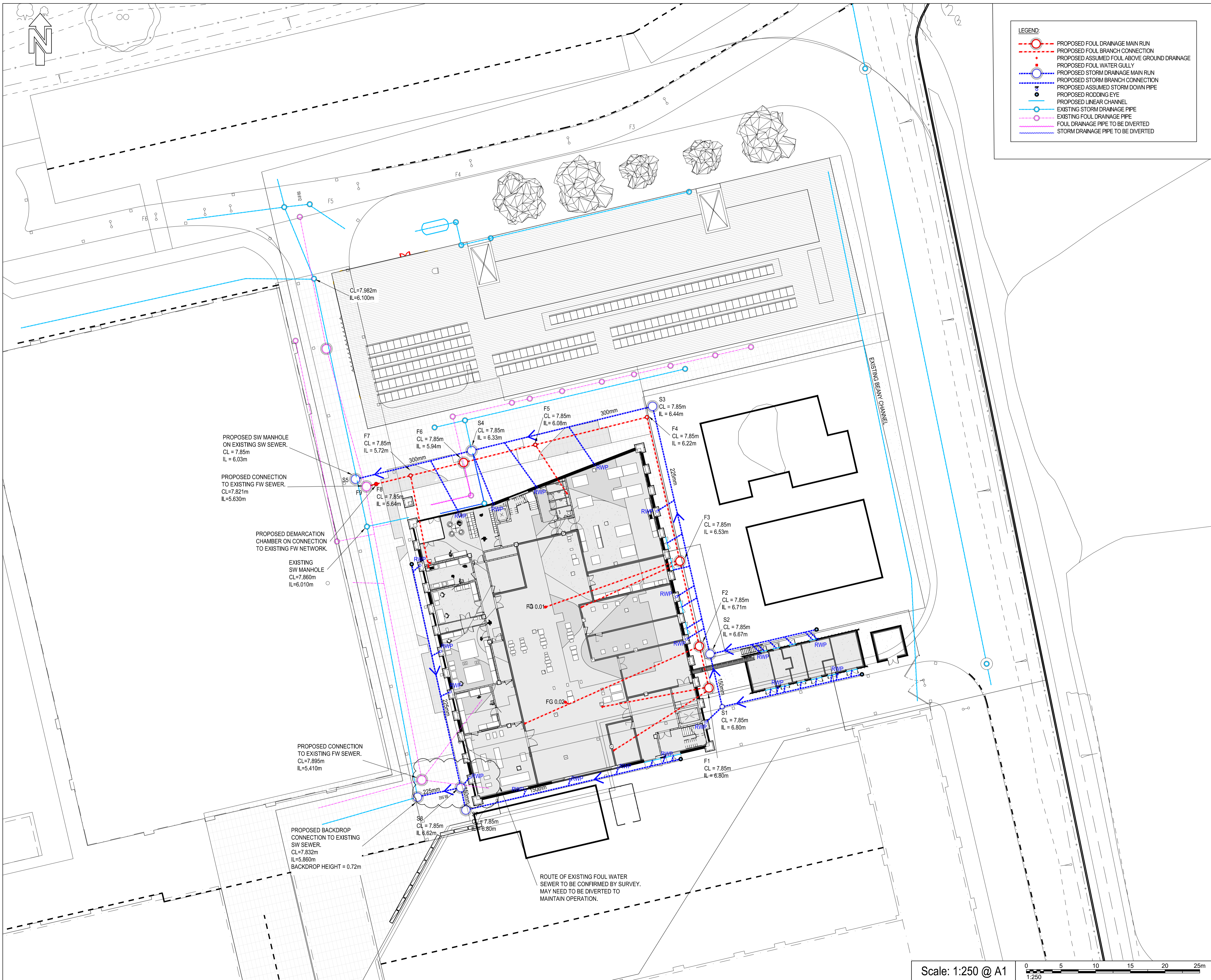

**LEGEND:**

- PROPOSED FOUL DRAINAGE MAIN RUN
- PROPOSED FOUL BRANCH CONNECTION
- PROPOSED ASSUMED FOUL ABOVE GROUND DRAINAGE
- PROPOSED FOUL WATER GULLY
- PROPOSED STORM DRAINAGE MAIN RUN
- PROPOSED STORM BRANCH CONNECTION
- PROPOSED ASSUMED STORM DOWN PIPE
- PROPOSED RODDING EYE
- PROPOSED LINEAR CHANNEL
- EXISTING STORM DRAINAGE PIPE
- EXISTING FOUL DRAINAGE PIPE
- FOUL DRAINAGE PIPE TO BE DIVERTED
- STORM DRAINAGE PIPE TO BE DIVERTED

# AECOM

**PROJECT**  
 University of Swansea  
 CISM Building

University of Swansea  
 Fabian Way, Skewen  
 Swansea, SA1 8EN

**CLIENT**  
 University of Swansea  
 Fabian Way, Skewen  
 Swansea, SA1 8EN  
 01792 205 678 tel  
 www.swansea.ac.uk

**CONSULTANT**  
 AECOM  
 Portwall Place, Portwall Lane  
 Bristol, BS1 6NA  
 0117 901 7000 tel 0117 701 7099 fax  
 www.aecom.com

**NOTES**

- Do not scale this drawing.
- All errors and omissions are to be reported to the Engineer for clarification.
- All dimensions are in metres unless noted otherwise.
- Surface water drainage to be designed to accommodate storms up to the 1 in 100 year return period, +30% allowance for climate change.
- All below ground rainwater pipe connections to be 150mmØ, unless indicated otherwise.
- All foul water below ground drainage connections to be 100mmØ, unless indicated otherwise.
- Public health layout to be confirmed by M&E engineer.
- Provisional positions of rain water pipes, positions need to be confirmed by architect.
- Finished floor level of building assumed to be 8.00mAOD as indicated on Drawing Ref. No. SU-INF-00-CE-BH-DR-G77-023 Rev. K.
- Gradient of foul water drainage network to be confirmed upon receipt of building public health layout.
- Information on existing surface and foul drainage network based on Drawing Ref. No. SU-INF-00-CE-BH-DR-G77-023 Rev. K.
- Exact location and depth of existing drainage on site to be confirmed.

**PURPOSE OF ISSUE**  
 Stage 3 Issue

**ISSUE/REVISION**

Rev	Date	Detail	Made	Chk'd	App'd
P1	16/06/2019	Stage 3 Issue	AE	DM	

**PROJECT NUMBER**  
 60605215

**SHEET TITLE**  
 Proposed Drainage  
 General Arrangement

**SHEET NUMBER**      **REV.**  
 60605215-ACM-XX-DR-CE-0001 P01

Scale: 1:250 @ A1

This drawing has been prepared for the use of AECOM's client. It may not be used, modified, reproduced or relied upon by third parties, except as agreed by AECOM or as required by law. AECOM accepts no responsibility and denies any liability whatsoever to any party that uses or relies on this drawing without AECOM's express written consent. Do not scale this document. All measurements must be obtained from the stated dimensions.